





507/26 Pacific Street Newcastle NSW

2  1  1 

Set on the fifth floor of the tightly held Essington Apartments, this north-facing residence plays to one of Newcastle's best outlooks. Light pours in from first glance, while uninterrupted views sweep across Foreshore Park to Nobbys, Fort Scratchley and stretch beyond the ocean toward Port Stephens. It's a dress circle seat to the harbour, where ships sail in and out and the sunrises are simply magical.

The layout is simple and well resolved. Open plan living and dining flow straight to the balcony, where mornings start with coffee in the sun and afternoons roll easily into a glass of wine. The kitchen sits connected without crowding the space, keeping everything practical and within reach. Both bedrooms are tucked quietly away from the social

Type : Apartment
Price : \$1,100,000 - \$1,150,000
View : <https://www.walkom.com.au/8653558>



Thomas Hook
02 4974 8900



Nicholas Scott
02 4974 8900

[For full version visit the website](https://www.walkom.com.au)

WM 0.90 W APPROX
REF 1.75 H X 0.80 W

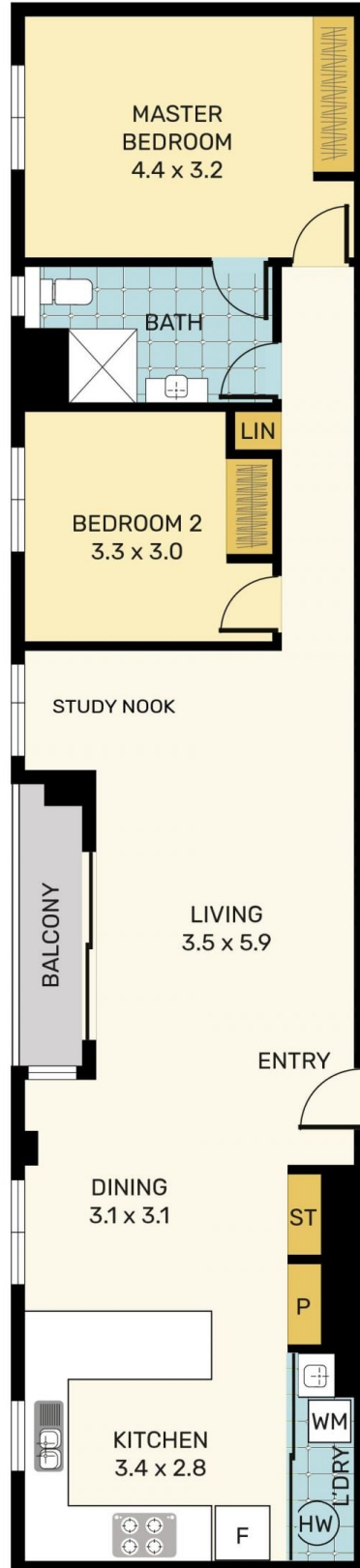

507/26 PACIFIC STREET, NEWCASTLE

Disclaimer: This information has been provided to us from the vendor and or their conveyancer or solicitor, no guarantee is given in respect of its accuracy. Any person viewing this information should make their own enquiries and only rely on those enquiries.
© 2022 Floor Plan National - All rights Reserved

